

INTEGRAL

2044UAP125R26-28S45 4xM8

EAN 4031582300161

Swivel castor with central, total lock and central directional lock, frame made of pressed steel, precision ball bearing in swivel head and wheel, housing cover made of synthetic plastics, stem with cam hole for profile bars. Wheel centre made of Polyamide, Tread: Polyurethane, precision ball bearing

Hint: TÜV Süd certified product.



BETTER MOBILITY. BETTER LIFE.



Picture may differ from original product

Technical Data

| | |
|------------------------|----------------|
| Wheel diameter | 125 mm |
| Wheel width | 32 mm |
| Castor width | 62 mm |
| Bolt-Ø | 28 mm |
| Bolt length | 96 mm |
| Dome-Ø | 62 mm |
| Offset | 35 mm |
| Swivel Interference | 195 mm |
| Overall height | 158 mm |
| Temperature | - 25 / - 25 °C |
| Standard | EN 12531 |
| Weight | 0.975 kg |
| Swivel Radius | 97.5 mm |
| Hardness of tread | Shore D 42 |
| Load capacity | 150 kg |
| Load capacity (static) | 300 kg |

Dimensions

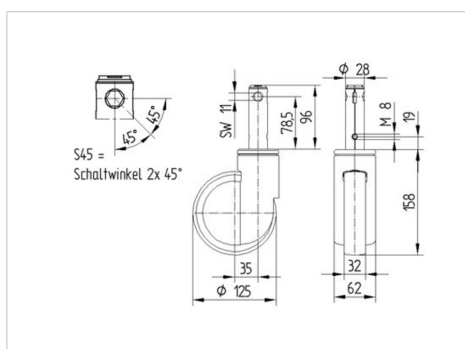

Advantages at a glance

| | |
|----------------------|-----------|
| Roll performance | ● ● ● ○ ○ |
| Movement noise | ● ● ● ○ ○ |
| Attrition | ● ● ● ● ○ |
| Corrosion resistance | ● ● ● ○ ○ |

INTEGRAL

2044UAP125R26-28S45 4xM8

EAN 4031582300161



BETTER MOBILITY. BETTER LIFE.

Structure & Mounting

