

# LEVINA

## 5370PJP150P30-13

EAN 4031582355048

Swivel castor, housing and wheels made from high grade synthetic materials, double ball bearing swivel head, bolt hole. Wheel centre made of Polypropylene, Tread: TENTEprene (thermoplastic rubber), grey non-marking, precision ball bearing



BETTER MOBILITY. BETTER LIFE.



Picture may differ from original product

### Technical Data

Wheel diameter	150 mm
Wheel width	32 mm
Castor width	59 mm
Centre hole	13 mm
Dome-Ø	59 mm
Offset	38 mm
Swivel Interference	226 mm
Overall height	190 mm
Temperature	- 10 / + 40 °C
Standard	EN 12530
Weight	0.624 kg
Swivel Radius	113 mm
Hardness of tread	Shore A 87
Load capacity	100 kg
Load capacity (static)	200 kg

### Advantages at a glance

Roll performance	● ● ● ○ ○
Movement noise	● ● ● ● ○
Attrition	● ● ● ○ ○
Corrosion resistance	● ● ● ● ○

### Structure & Mounting

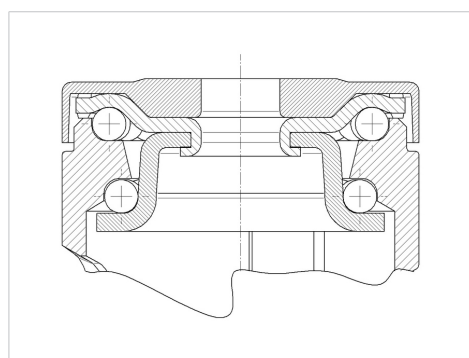

# LEVINA

5370PJP150P30-13

EAN 4031582355048



BETTER MOBILITY. BETTER LIFE.

## Structure & Mounting

---

